

# Cleaning guide for the dental milling machine MD-500

This manual describes the cleaning methods required to use the MD-500. If you use it without cleaning, you may not be able to obtain the full performance of MD-500. Also, be careful not to damage the MD-500 when cleaning.

Precautions for safe use of MD-500 and more detailed contents are described in the "MD-500 Instruction Manual", so it is recommended to read them together.

## **⚠ Caution**

Be sure to wear a mask and protective goggles when cleaning.

## 1. Cleaning the collet holder

The collet holder to which the bur is attached consists of three parts.

Wipe the outer and inner surfaces of the collet nut, collet chuck, and collet holder with a dry cloth to remove chips before installing the tool.

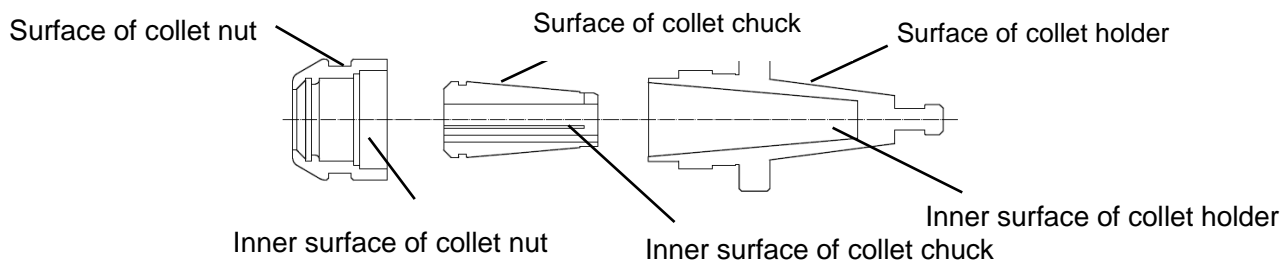
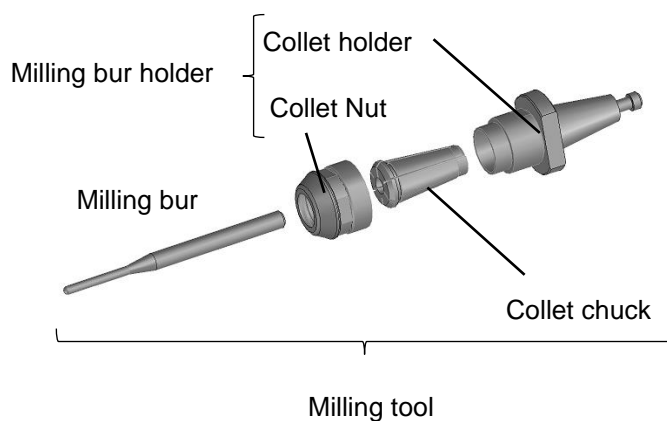

Fig. Cross section

## **⚠ Caution**

If the milling bur is attached together with chips, runout may occur and the machining accuracy may be affected.

Set the milling bur after fitting the collet chuck on the collet nut side.

The collet chuck may get stuck in the collet holder and may not come off.

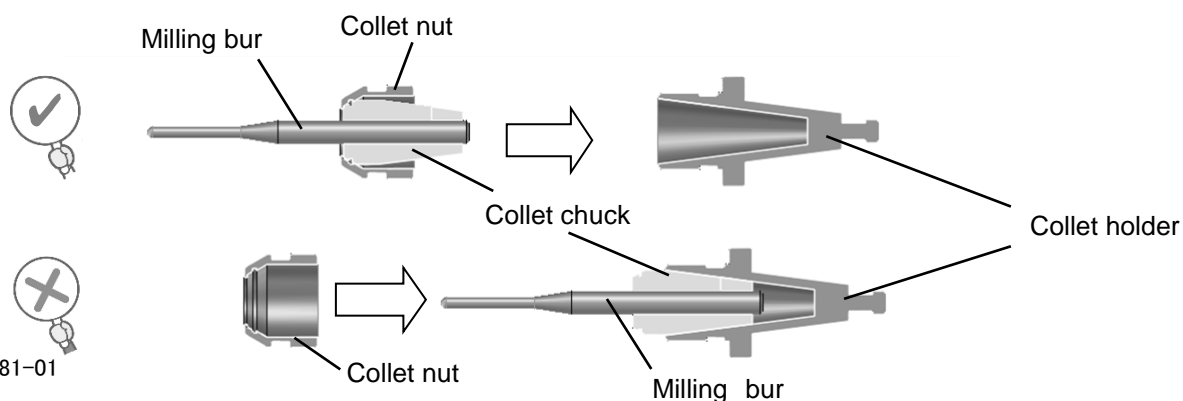

## 2. Cleaning the inner surface of the spindle

Wipe the inner surface of the spindle with a soft dry cloth to remove chips before starting milling. When cleaning, do not let chips get inside the spindle.

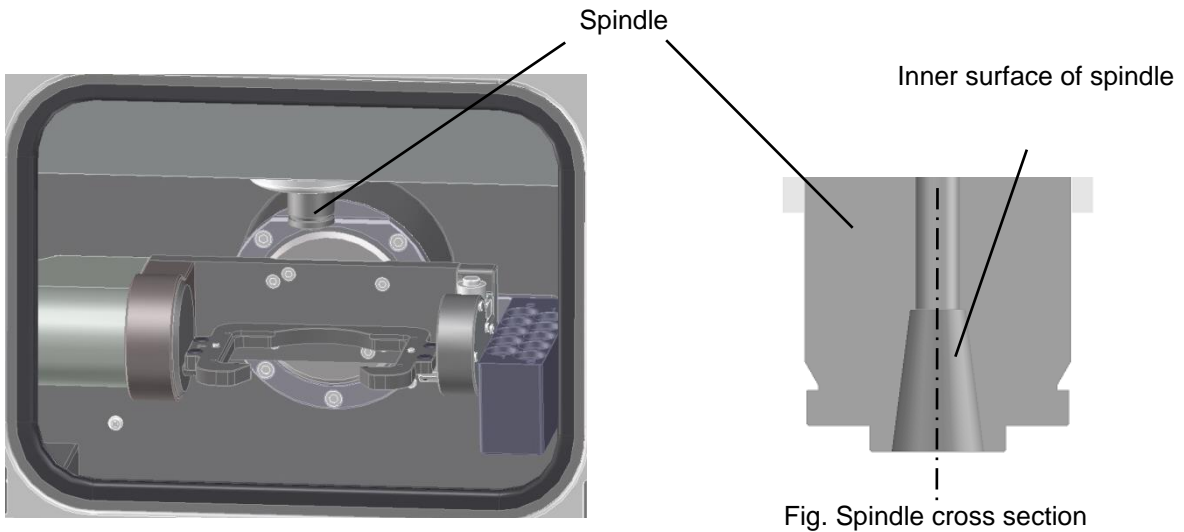

### **⚠ Caution**

If the spindle chucks the collet holder with chips attached, runout may occur and the milling accuracy may be affected. Also, the collet holder may not come off the spindle when changing tools.

## 3. Cleaning the disk fixing plate type C

Before attaching the disk fixing plate type C to the mounting plate of MD-500, clean it with a dust collector or a dry cloth. Clean the back side of the disk fixing plate as well.



### **⚠ Caution**

If a disk with chips is attached, the proper fixing force may not be obtained and the machining accuracy may be affected.

## 4. Cleaning the swivel table

Before attaching the disk fixing plate type C on the mounting plate of the swivel table, clean the mounting plate surrounded by the square in the figure below using a dust collector or a dry cloth.

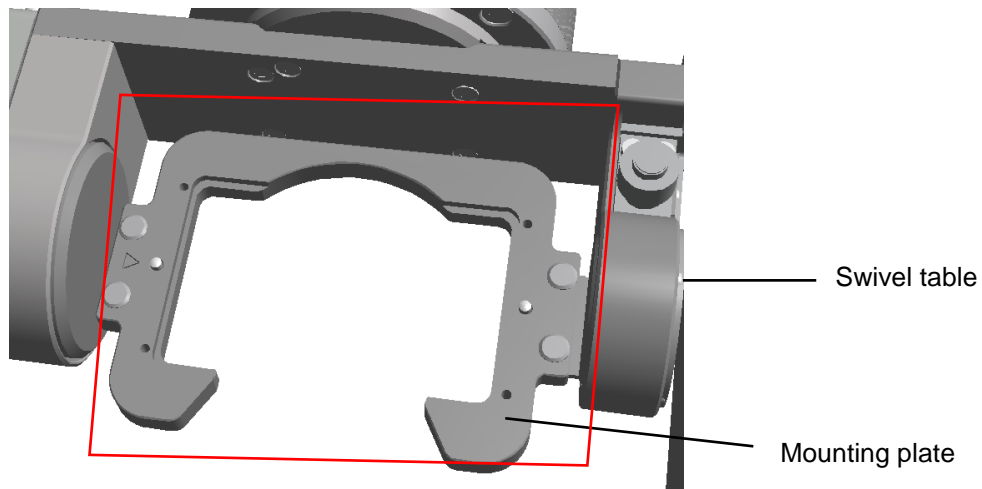

### **⚠ Caution**

If the disk fixing plate has chips, it will not be possible to obtain the proper fixing force, which may affect the milling accuracy. Especially, semi-sintered materials such as zirconia can cause cracks.

## 5. Cleaning the ATC tool magazine

Clean up touch sensor and the ATC tool magazine surrounded by the square in the figure below in using a dust collector or a dry cloth, before setting the milling bur holder in the ATC tool magazine. For ATC tool magazine, also clean the inner surface of the hole for setting the milling bur holder.

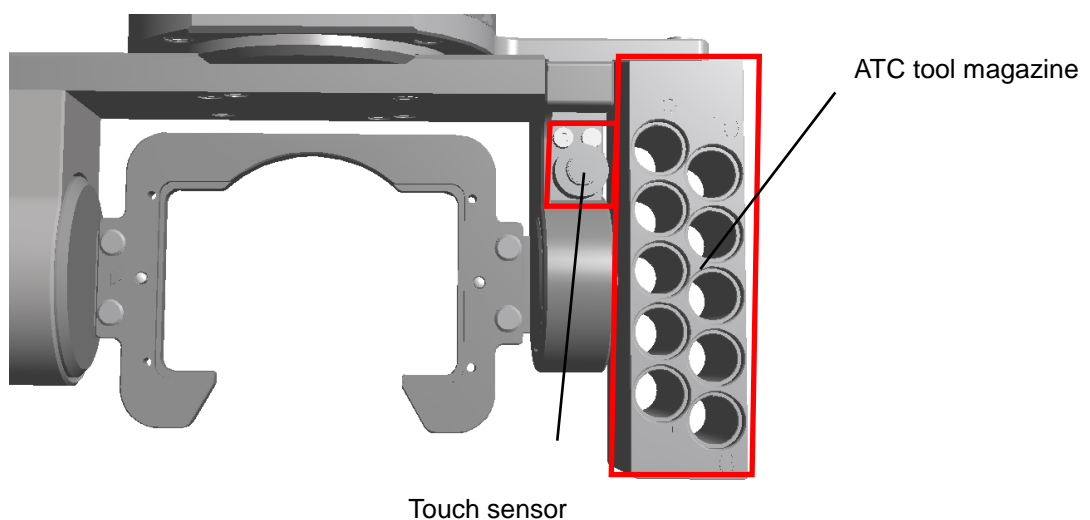

### **⚠ Caution**

If the collet holder is set with chips in the ATC tool magazine, the collet holder may tilt due to the chips, and the spindle may not be able to chuck the collet holder automatically. Also, if the touch sensor is used with chips accumulated, it may affect the processing accuracy.

Revision history

Version	Date	Revision Details
01	2022.01.14	First version

Please contact us at the address below if you have questions or inquiries

Customer Support & Service Center

**Ecology Products Group, Ecology Products Sales Div.**

**Canon Electronics Inc.**

3-5-10 Shibakoen, Minato-ku, Tokyo 105-0011 Japan

Tel.: 81-3-6910-4128

Fax: 81-3-5472-0621

E-mail: [healthcare@canon-elec.co.jp](mailto:healthcare@canon-elec.co.jp)

6Y2-0081-01 CE © CANON ELECTRONICS INC. 2022